



## Installation Guide Gen 3 MINI F54 through F60



### Rear Sway Bar Link Installation Part # 70-510100 & 70-510200



M7 Speed engineers and manufactures the highest quality and best fitting MINI Cooper accessories and performance parts available anywhere on Planet Earth! Please inspect your parts when you receive them to verify everything is included and no damage has happened during shipment. Read these instructions completely BEFORE attempting to install this product. If you are not confident you can do the work described or do not have the tools or skills necessary please contact a local M7 dealer (listed on our website [www.m7speed.com](http://www.m7speed.com)) or a local MINI repair shop or automotive accessory installation center to perform this work. We acknowledge not everything is perfect but we work very hard every day to improve our products and make installations easier. If you have any comments please contact M7 Customer Service directly at 704-663-0094. We encourage and welcome any and all criticism, comments or product reviews. Thank you.



#### **NOTE:**

**THIS GUIDE ONLY OUTLINES THE MAJOR STEPS REQUIRED TO PERFORM THE INSTALLATION. STANDARD INDUSTRY PRACTICES AND GENERAL KNOWLEDGE OF VEHICLE ASSEMBLY AND DISASSEMBLY ARE NOT DETAILED IN THIS GUIDE. THE INSTALLER ASSUMES ALL RESPONSIBILITY AND LIABILITY FOR ANY DAMAGE ENCOUNTERED WHILE INSTALLING THESE PARTS. IN ADDITION, THE INSTALLER ASSUMES ALL RESPONSIBILITY AND LIABILITY FOR ANY DAMAGES OR INJURY THAT ARE A DIRECT OR INDIRECT RESULT OF IMPROPER INSTALLATION AND/OR POOR WORKMANSHIP.**



## **CAUTION:**

**WHEN WORKING UNDER YOUR CAR ALWAYS USE THE RIGHT EQUIPMENT FOR THE JOB. DON'T BE TEMPTED TO TAKE SHORT CUTS OR USE INAPPROPRIATE ITEMS. NEVER WORK UNDERNEATH A VEHICLE THAT IS ONLY SUPPORTED BY A JACK. THIS MAY CAUSE SEVERE INJURY AND EVEN DEATH.**



## **CAUTION:**

**SUPPORT YOUR CAR BY USING STABLE AND QUALITY AXLE STANDS THAT ARE IN GOOD CONDITION AND PROPERLY RATED FOR YOUR VEHICLE'S WEIGHT. THIS INSTALLATION IS BEST ACCOMPLISHED USING AN AUTOMOTIVE SERVICE LIFT.**

### **KIT INCLUDES:**

- **2 x Rear Sway Bar Links + Hardware Kit**

### **DIS-ASSEMBLY:**

1. Remove the plastic shields mounted to the bottom of the rear swing arms [8mm Socket]
2. Remove the rear sway bar links completely from the rear suspension swing arm and the rear sway bar on both sides of the vehicle. [E12 Socket, T30 socket, 14mm wrench]. These parts will not be reused.

### **RE-ASSEMBLY**

#### **INSTALL THE MAXX-G REAR SWAY BAR LINKS SEE FIGURE #1**

1. Set both links to the same center to center length.
  - a. 2.5" Lifted Cars (6" [152mm])
  - b. Standard Ride Height Cars (4" [101mm])
  - c. Lowered Cars (Minimum Center to center length)
2. Lock the Jam Nut on the tie rod end to link body.
3. Pre grease the bushings prior to installation through the Zerk fitting on the bottom of the link.
4. Insert the ball joint stud into the rear sway bar hole.
  - a. Place one thick washer on each stud.
  - b. Install the M10 castle nuts.
  - c. Torque to 30 lb-ft [40Nm]
  - d. Install the supplied cotter pins.
5. Install the lower pivot point using the supplied M8 bolt, split lock washer and large diameter washers and thread it into the lower swing arm in the OE location.
6. Torque the lower pivot bolt to 25 lb-ft [34Nm].
7. Reinstall all the sensor wires into their mounting brackets if removed.
8. Reinstall the plastic guards onto the bottom of the Rear Swing Arms if removed.

ITEM NO.	DESCRIPTION	QTY.
1	MAXX-G LINK BODY	1
2	URETHANE BUSHING	2
3	STEEL BUSHING	1
4	MB FENDER WASHER	2
5	BALL JOINT END	1
6	M12-1.25 RH JAM NUT	1
7	MB-1.25 X 55MM LG SHCS	1
8	MB SPLIT RING LOCK WASHER	1
9	M10 CASTLE NUT	1
10	COTTER PIN	1
11	ZERK FITTING	1

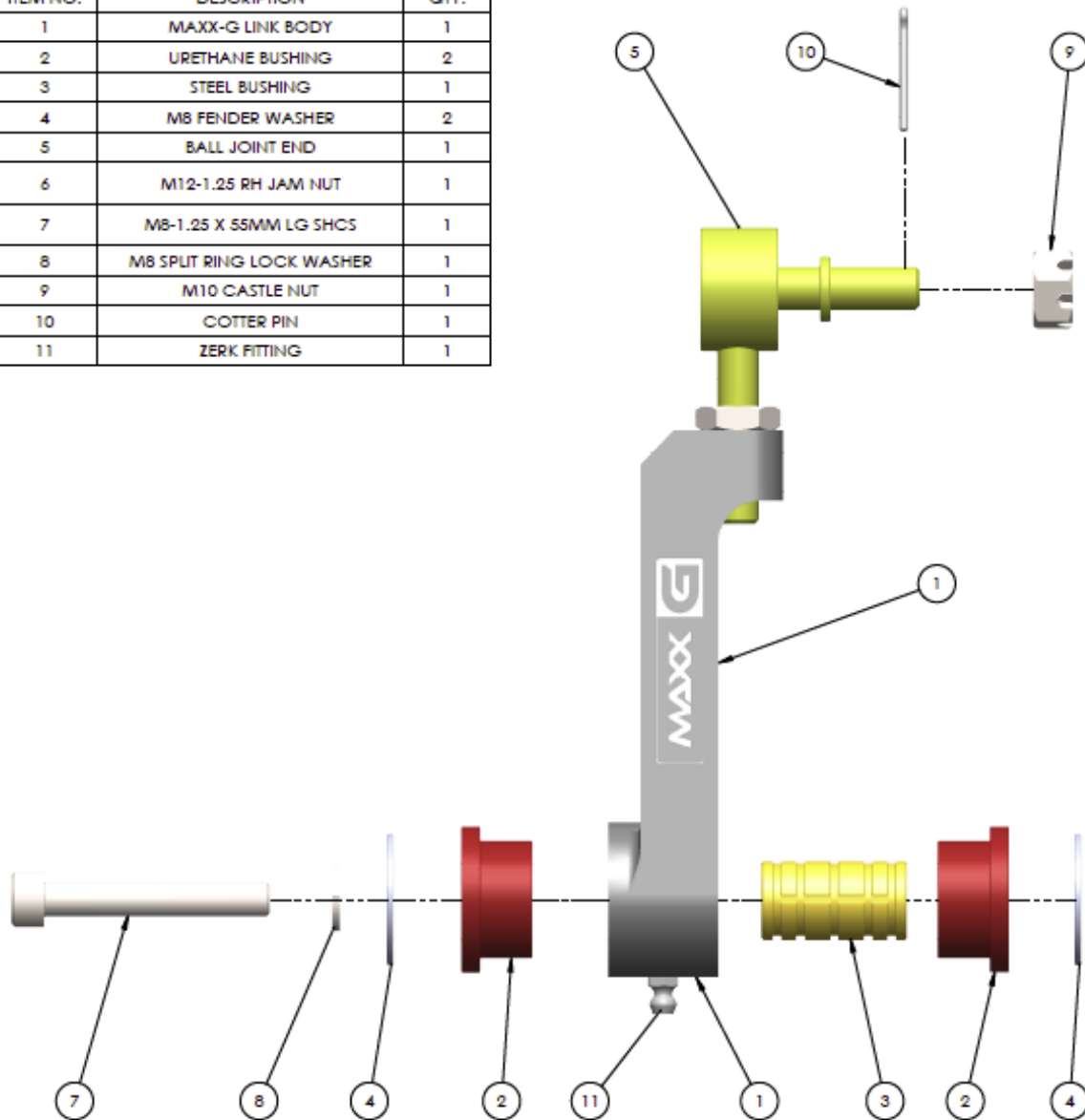

**NOTE:**

When both sides of the rear suspension reassembly is completed safety check all components for proper and complete installation and correct hardware tightness.